

## Item 2593

### 1. Product description:

Quick-Change Disc Adapter

**Dimensions (in):** 5/8"-11H a 1/4"-20H

**Material:** Metal

**Specification:** DC RAPIDO

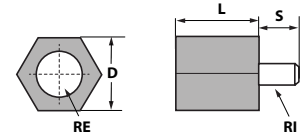
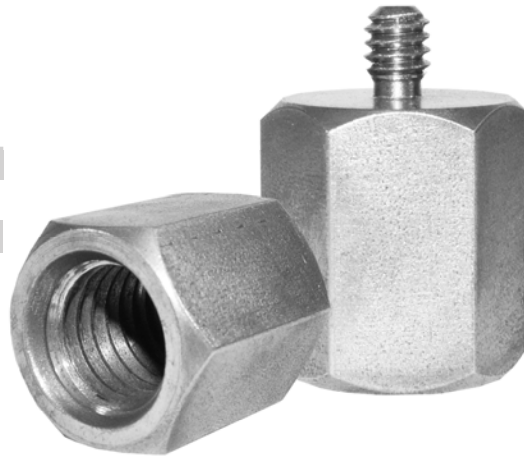

RI = 1/4" - 20H  
RE = 5/8" - 11H  
D = 22.23 mm  
L = 25.4 mm  
S = 12 mm



Angle Grinder

### 1. Application

- For mounting quick-change disc backing pads.
- Steel adapter for increased durability.
- Specially designed for mounting backing pads with Spin-On and Roloc systems.

### 2. Operating instructions

- Thread the adapter onto the 5/8"-11H spindle and secure it with the lock nut.
- Tighten using a 7/8" open-end wrench.
- Mount backing pads (items 2595 to 2598, 2577, 2578, 628, and 629).
- Attach the quick-change disc onto the adapter.
- Proceed with the operation.
- Do not apply excessive pressure on the workpiece.

### 3. Safety information

- Always use proper personal protective equipment (PPE).
- Improper use may cause severe injury.
- Operate at low speed and with light pressure to prevent premature machine wear.
- Do not exceed 13,300 RPM.
- Use the correct wrench for tightening.

### 4. Handling

- Initial inspection must be carried out in the original packaging. If visible damage is detected, the product should not be accepted.
- Handle the adapter carefully to prevent impacts or drops that may reduce its service life.

### 5. Storage

- Store the adapter on a flat surface at least 10 cm above ground level, away from moisture, extreme temperatures, or any type of fluid.

### 6. Packaging units

- 1 piece.